

SFS CAT								
Наименование	РАЗМЕР НА МАРКУЧА		РЕЗБА	РАЗМЕРИ			НАЛЯГАНЕ	
	Диам.	inch	F	D	A	L	bar	PSI
SFS CAT 20 3/4"	20	3/4"	3/4"	41.3	58	99	350	5000
SFS CAT 20 1"	20	3/4"	1"	47.6	70	111	350	5000
SFS CAT 25 1"	25	1"	1"	47.6	72	127	280	4000
SFS CAT 25 1 1/4"	25	1"	1 1/4"	54	75	130	280	4000
SFS CAT 32 1 1/4"	32	1 1/4"	1 1/4"	54	71	131	210	3000
SFS CAT 32 1 1/2"	32	1 1/4"	1 1/2"	63.5	80	141	210	3000
SFS CAT 40 1 1/2"	40	1 1/2"	1 1/2"	63.5	80	151	185	2700

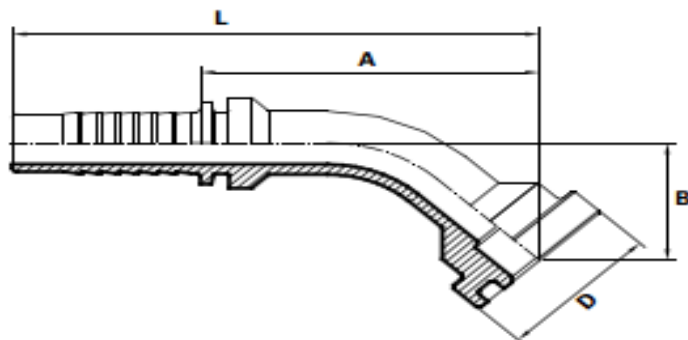

SFS SUPERCAT 45C									
Наименование	РАЗМЕР НА МАРКУЧА		РЕЗБА	РАЗМЕРИ				НАЛЯГАНЕ	
	Диам.	inch	F	D	B	A	L	bar	PSI
SFS CAT 45C 20 3/4"	20	3/4"	3/4"	41.3	39	74	115	350	5000
SFS CAT 45C 20 1"	20	3/4"	1"	47.6	43	78	119	350	5000
SFS CAT 45C 25 1"	25	1"	1"	47.6	40	94	149	280	4000
SFS CAT 45C 25 1 1/4"	25	1"	1 1/4"	54.0	43	97	152	280	4000
SFS CAT 45C 32 1 1/4"	32	1 1/4"	1 1/4"	54.0	50	107	168	210	3000
SFS CAT 45C 32 1 1/2"	32	1 1/4"	1 1/2"	63.5	51	108	169	210	3000
SFS CAT 45C 40 1 1/2"	40	1 1/2"	1 1/2"	63.5	49	120	191	185	2700

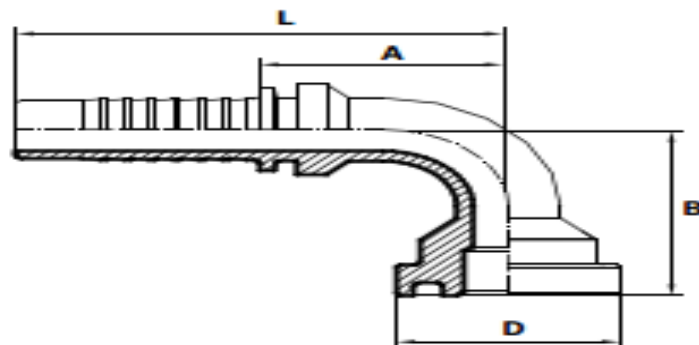

SFS SUPERCAT 90C									
Наименование	РАЗМЕР НА МАРКУЧА		РЕЗБА	РАЗМЕРИ				НАЛЯГАНЕ	
	Диам.	inch	F	D	B	A	L	bar	PSI
SFS CAT 90C 20 3/4"	20	3/4"	3/4"	41.3	67	57	98	350	5000
SFS CAT 90C 20 1"	20	3/4"	1"	47.6	73	57	98	350	5000
SFS CAT 90C 25 1"	25	1"	1"	47.6	75	77	132	280	4000
SFS CAT 90C 25 1 1/4"	25	1"	1 1/4"	54.0	80	77	132	280	4000
SFS CAT 90C 32 1 1/4"	32	1 1/4"	1 1/4"	54.0	97	89	150	210	3000
SFS CAT 90C 32 1 1/2"	32	1 1/4"	1 1/2"	63.5	99	89	150	210	3000
SFS CAT 90C 40 1 1/2"	40	1 1/2"	1 1/2"	63.5	113	101	172	185	2700