

Накрайник ORFS – DK

с гумено челно уплътнение

КОД	DN	Inch	Резба	CH	A	L	PN /bar/
DK 6 9/16"	6	1/4"	9/16"	17	20.5	48.5	450
DK 6 11/16"	6	1/4"	11/16"	22	23	51	450
DK 8 11/16"	8	5/16"	11/16"	22	23	51	350
DK 10 11/16"	10	3/8"	11/16"	22	23.5	53.5	445
DK 10 13/16"	10	3/8"	13/16"	24	26	56	445
DK 12 13/16"	12	1/2"	13/16"	24	26.5	59.5	415
DK 12 1"	12	1/2"	1"	30	30	63	415
DK 12 1.3/16"	12	1/2"	1.3/16"	36	32.5	65	415
DK 16 1"	16	5/8"	1"	30	30	66	350
DK 16 1.3/16"	16	5/8"	1.3/16"	36	32	68.5	350
DK 20 1.3/16"	20	3/4"	1.3/16"	36	33	74	350
DK 20 1.7/16"	20	3/4"	1.7/16"	41	34	75	350
DK 25 1.7/16"	25	1"	1.7/16"	41	35	90	280
DK 32 1.11/16"	32	1.1/4"	1.11/16"	50	35.5	96	210
DK 40 2"	40	1.1/2"	2"	60	37	108	185

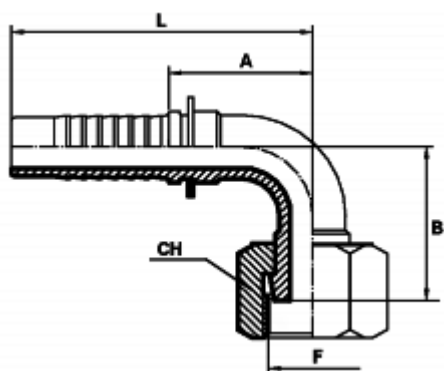

**Накрайник ORFS – DK 90°
с гумено челно уплътнение**

КОД	DN	Inch	Резба	CH	B	A	L	PN /bar/
DK 90C 6 9/16"	6	1/4"	9/16"	17	29.5	28	56	450
DK 90C 6 11/16"	6	1/4"	11/16"	22	30	28	56	450
DK 90C 8 11/16"	8	5/16"	11/16"	22	29	29	56.5	350
DK 90C 10 11/16"	10	3/8"	11/16"	22	29	36	66	445
DK 90C 10 13/16"	10	3/8"	13/16"	24	32	34	64	445
DK 90C 12 13/16"	12	1/2"	13/16"	24	36	37.5	70.5	415
DK 90C 12 1"	12	1/2"	1"	30	39	39	72	415
DK 90C 12 1.3/16"	12	1/2"	1.3/16"	36	41	38	71	415
DK 90C 16 1"	16	5/8"	1"	30	43.5	51.5	87.5	350
DK 90C 16 1.3/16"	16	5/8"	1.3/16"	36	48	46.5	82.5	350
DK 90C 20 1.3/16"	20	3/4"	1.3/16"	36	49	56	96.5	350
DK 90C 20 1.7/16"	20	3/4"	1.7/16"	41	54	56.5	97	350
DK 90C 25 1.7/16"	25	1"	1.7/16"	41	59.5	74	129	280
DK 90C 32 1.11/16"	32	1.1/4"	1.11/16"	50	75.5	90	150.5	210
DK 90C 40 2"	40	1.1/2"	2"	60	84	99	170	185

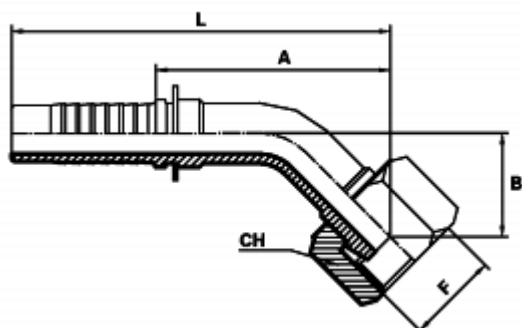

**Накрайник ORFS – DK 45°
с гумено челно уплътнение**

КОД	DN	Inch	Резба	CH	B	A	L	PN /bar/
DK 45C 6 9/16"	6	1/4"	9/16"	17	15	45	73	450
DK 45C 6 11/16"	6	1/4"	11/16"	22	15.5	45.5	73.5	450
DK 45C 8 11/16"	8	5/16"	11/16"	22	15.5	46	74	350
DK 45C 10 11/16"	10	3/8"	11/16"	22	13	51	81	445
DK 45C 10 13/16"	10	3/8"	13/16"	24	17	52	82	445
DK 45C 12 13/16"	12	1/2"	13/16"	24	18	58	91	415
DK 45C 12 1"	12	1/2"	1"	30	20	61	94	415
DK 45C 12 1.3/16"	12	1/2"	1.3/16"	36	24	62	95	415
DK 45C 16 1"	16	5/8"	1"	30	20	55	91	350
DK 45C 16 1.3/16"	16	5/8"	1.3/16"	36	21	57	93	350
DK 45C 20 1.3/16"	20	3/4"	1.3/16"	36	23	58	98	350
DK 45C 20 1.7/16"	20	3/4"	1.7/16"	41	27	62.5	103	350
DK 45C 25 1.7/16"	25	1"	1.7/16"	41	26	81	136	280
DK 45C 32 1.11/16"	32	1.1/4"	1.11/16"	50	34	93	152.5	210
DK 45C 40 2"	40	1.1/2"	2"	60	45	112	182	185