

**SFL прав накрайник  
капилярно запояване  
3000 PSI**

КОД	DN	Inch	Резба	D	A	L
SFL 12 1/2"	12	1/2"	1/2"	30.2	49	82
SFL 12 3/4"	12	1/2"	3/4"	38.1	52	84
SFL 16 1/2"	16	5/8"	1/2"	30.2	49	85
SFL 16 5/8"	16	5/8"	5/8"	34	49	85
SFL 16 3/4"	16	5/8"	3/4"	38.1	48	84
SFL 20 1/2"	20	3/4"	1/2"	30.2	47	88
SFL 20 3/4"	20	3/4"	3/4"	38.1	47	88
SFL 20 1"	20	3/4"	1"	44.5	50	91
SFL 25 3/4"	25	1"	3/4"	38.1	50	91
SFL 25 1"	25	1"	1"	44.5	50	105
SFL 25 1.1/4"	25	1"	1.1/4"	50.8	67	120
SFL 32 1"	32	1.1/4"	1"	44.5	57	117
SFL 32 1.1/4"	32	1.1/4"	1.1/4"	50.8	65	125
SFL 32 1.1/2"	32	1.1/4"	1.1/2"	60.3	70	130
SFL 40 1.1/2"	40	1.1/2"	1.1/2"	60.3	70	141
SFL 40 2"	40	1.1/2"	2"	71.4	72	143
SFL 50 2"	50	2"	2"	71.4	73	153

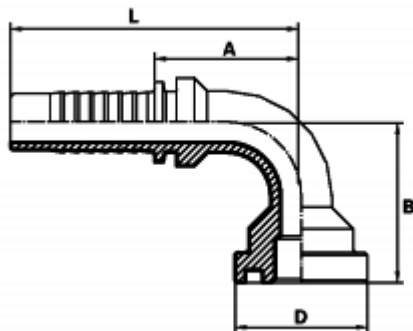

**SFL накрайник ъгъл 90°**  
**капилярно запояване**  
**3000 PSI**

КОД	DN	Inch	Резба	D	B	A	L
SFL 90C 12 1/2"	12	1/2"	1/2"	30.2	43	39	72
SFL 90C 12 3/4"	12	1/2"	3/4"	38.1	50	39	72
SFL 90C 16 1/2"	16	5/8"	1/2"	30.2	49	49	85
SFL 90C 16 3/4"	16	5/8"	3/4"	38.1	55	49	85
SFL 90C 20 1/2"	20	3/4"	1/2"	30.2	52	57	98
SFL 90C 20 3/4"	20	3/4"	3/4"	38.1	58	57	98
SFL 90C 20 1"	20	3/4"	1"	44.5	62	57	98
SFL 90C 25 3/4"	25	1"	3/4"	38.1	60	77	132
SFL 90C 25 1"	25	1"	1"	44.5	64	77	132
SFL 90C 25 1.1/4"	25	1"	1.1/4"	50.8	70	77	132
SFL 90C 32 1"	32	1.1/4"	1"	44.5	82	89	150
SFL 90C 32 1.1/4"	32	1.1/4"	1.1/4"	50.8	87	89	150
SFL 90C 32 1.1/2"	32	1.1/4"	1.1/2"	60.3	88	89	150
SFL 90C 40 1.1/2"	40	1.1/2"	1.1/2"	60.3	102	101	172
SFL 90C 40 2"	40	1.1/2"	2"	71.4	118	101	172
SFL 90C 50 2"	50	2"	2"	71.4	120	144	224

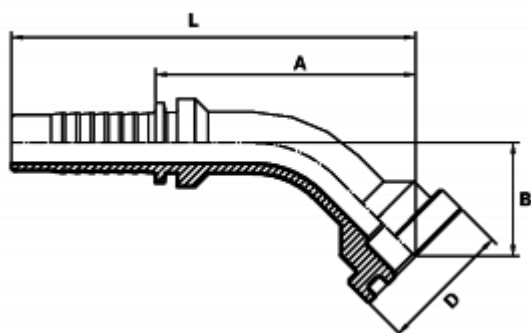

**SFL накрайник ъгъл 45°**  
**капилярно запояване**  
**3000 PSI**

КОД	DN	Inch	Резба	D	B	A	L
SFL 45C 12 1/2"	12	1/2"	1/2"	30.2	23	63	96
SFL 45C 12 3/4"	12	1/2"	3/4"	38.1	28	68	101
SFL 45C 16 1/2"	16	5/8"	1/2"	30.2	26	59	95
SFL 45C 16 3/4"	16	5/8"	3/4"	38.1	30	63	99
SFL 45C 20 1/2"	20	3/4"	1/2"	30.2	28	63	104
SFL 45C 20 3/4"	20	3/4"	3/4"	38.1	32	67	108
SFL 45C 20 1"	20	3/4"	1"	44.5	35	70	111
SFL 45C 25 3/4"	25	1"	3/4"	38.1	35	83	138
SFL 45C 25 1"	25	1"	1"	44.5	32	86	141
SFL 45C 25 1.1/4"	25	1"	1.1/4"	50.8	36	90	145
SFL 45C 32 1"	32	1.1/4"	1"	44.5	36	96	157
SFL 45C 32 1.1/4"	32	1.1/4"	1.1/4"	50.8	43	100	161
SFL 45C 32 1.1/2"	32	1.1/4"	1.1/2"	60.3	44	101	162
SFL 45C 40 1.1/2"	40	1.1/2"	1.1/2"	60.3	41	112	183
SFL 45C 40 2"	40	1.1/2"	2"	71.4	52	123	194
SFL 45C 50 2"	50	2"	2"	71.4	59	148	228